

OPTICATH® ScvO₂ Probe with Fluidic Seal: Abbreviated Setup Instructions*

1. Power on monitor and connect optical module. Allow 15 minutes for optical module to stabilize.
2. Connect optical module to the probe's optical connector and perform a pre-insertion calibration on the SO₂ computer per manufacturer instructions.
3. After the pre-insertion calibration, remove the probe and fluidic seal from the calibration block and packaging. Activate the plunger on the fluidic seal and retract the probe tip (approximately 5 cm) until it is protected within the tubing. Attach a primed flush line or pressure monitoring line to side port of fluidic seal.
4. Activate flush and prime fluidic seal and tubing to distal tip. Ensure no air is entrapped in the tubing.

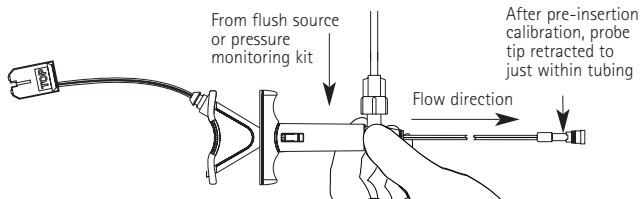

5. Attach primed fluidic seal device to the distal (yellow) lumen of indwelling central venous catheter. Must be 16 G or larger.

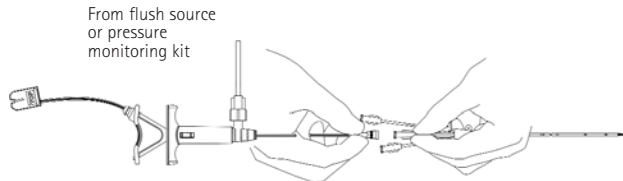

6. Activate flush mechanism and ensure patency by observing flow in drip chamber. Level and zero-balance transducer.

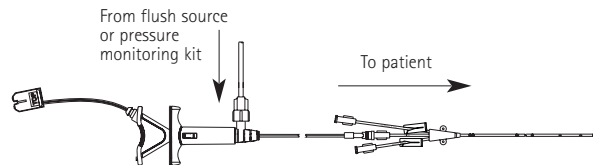

7. Advance fiberoptic probe by activating the plunger on the fluidic seal syringe. Push the sheathed portion of the probe into the syringe plunger until the marking towards the distal end of the probe sheath reaches the female luer on the central venous catheter's distal lumen. Release plunger to activate fluidic seal. Check positioning with X-ray or fluoroscope. Secure contamination guard to fluidic seal.

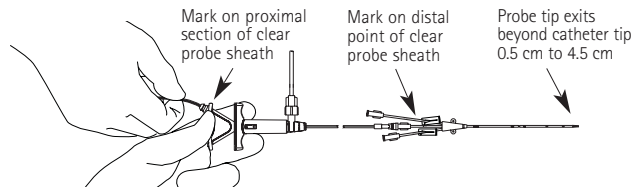

8. Perform light intensity baseline/calibration.

*Not intended to replace Instructions for Use. For complete Instructions for Use that includes all contraindications, warnings and precautions, see device insert.

Guidelines for Early Goal-Directed Therapy¹

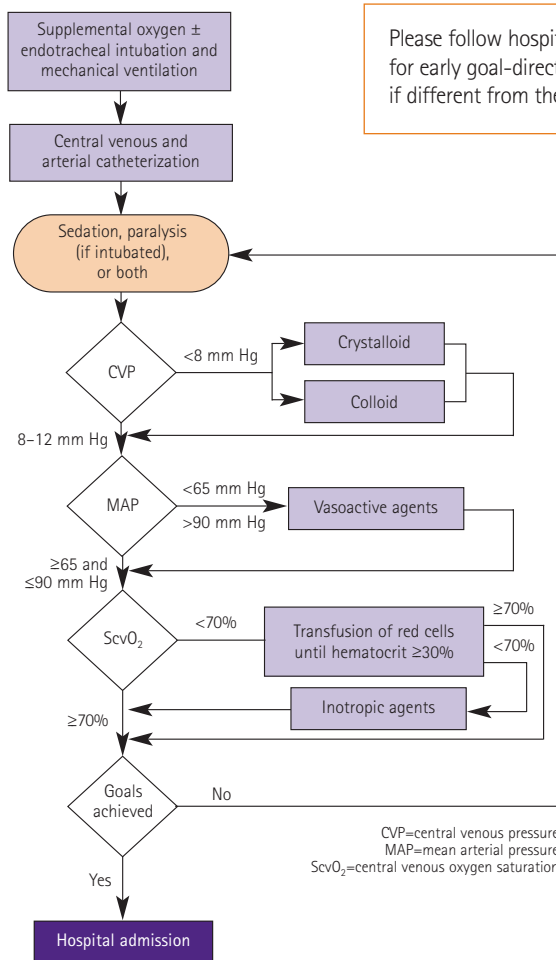

Reference: 1. Rivers E, Nguyen B, Havstad S, et al, for the Goal-Directed Therapy Collaborative Group. Early goal-directed therapy in the treatment of severe sepsis and septic shock. *N Engl J Med.* 2001;345:1368-1377.
 © 2001 Massachusetts Medical Society. All rights reserved. Adapted with permission, 2006.